



TH+ RANGE PIVOTING

PRODUCT INFORMATION

With its 32-mm or 44-mm-thick double or triple glazing, the Vitrocsa TH+ range is suitable for pivoting glazed surfaces of up to 600 kg and 12 m² per pane depending on the wind resistance. The pivoting surface may be integrated as a main entrance door for a villa or as an access door for a patio with a visible frame of just 50 mm. The sophisticated closing system is ingeniously integrated in the lower section, enabling the door to be locked and providing a perfect seal.

This system resembles a watch mechanism, and is completely hidden inside the frame. The pivot axis may be central or offset (at least 270 mm) to create a larger opening, and a pivoting surface may be next to a sliding or fixed door.

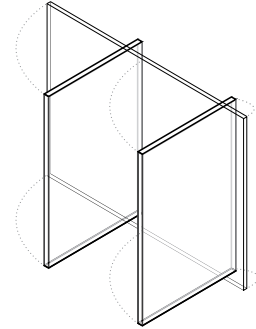

RAILS + FRAMES

- Embedded and concealed in the floor, wall and ceiling
- Frame just 140 mm wide for a birail (mono: 64 mm + 12 mm seal)
- Saline treatment specially adapted for coastal projects

CLOSURE MECHANISM

- 2-point closure button (092)
- Rack
- Cylinder
- RCI electric closure
- Alarms

VERTICAL CONNECTION

- 22 mm
- Reinforced for very windy locations or installation at high altitudes

GLAZING

- 32 mm or 44 mm
- Panels 600 kg and 12 m²

MAIN CROSS SECTIONS

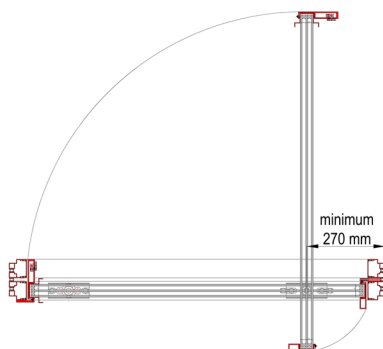

OPTIONS

- Pivoting (up to 600 kg and 12 m²)

VITROCSA Headquarters
Orchidées Constructions SA
Rue de la Gare 8
2024 Saint-Aubin-Sauges
Switzerland

T +41 24 436 22 02
F +41 24 436 22 02
www.vitrocsa.com
info@vitrocsa.com

V I T R O C S A

THE MINIMALIST WINDOW



TH+ RANGE PIVOTING

PERFORMANCE

To clearly demonstrate the properties of the VITROCSA TH+ PIVOTING window, we have conducted standardised tests in an accredited laboratory (SWISS TESTING SERVICE NUMBER STS 317).

The results of these investigative tests are shown in the table below:

TH+ pivoting	Normes (test et classification)	Classification
Air permeability	EN 1026 (test) EN 12207 (classification)	Class 3
Water permeability	EN 1027 (test) EN 12208 (classification)	Class 8A
Wind resistance	EN 12211 (test) EN 12210 (classification)	Class C3/B4